



Bay Front

VILLAS & APARTMENTS

Groundbreaking is the word used to describe Bay Front, Portmore's newest gated community offering single-family homes and apartments in a one-of-a-kind harbour setting. Located less than 3km (2 miles) from the Portmore toll plaza, Bay Front transforms a historic landmark into a residential community with amenities desired by today's homeowners.

View our
model
homes!



The Villas offer contemporary 2-bedroom 2-bathroom homes with meticulously finished living space of 77m² (832 ft²) on lots averaging (278m²) (3,000 ft²).

Prices start at J\$11.9 M

Property Highlights

- Gatehouse with 24-hour security and CCTV
- Membership to the Bay Front Club with swimming pool, all-purpose courts, recreational amenities (Phase 2)
- Walking distance to Bay Front Marina (Phase 3)
- Private beachfront
- Park & Children's playground





Attractive standard features:

- Master bedroom en suite and generous closets
- Top of the line fixtures and upgrades
- Shaker-style hardwood cabinetry in kitchen and bathrooms
- Solid surface countertops and mosaic wall tile accents
- Ceramic floor tiles, 450mm (18") square throughout
- Laundry closet piped for washer & dryer with tub
- Brick pavers driveway
- Solar water heater
- Pre-wired for telephone and cable
- UPVC energy efficient windows



Optional Patio



Contact us today

20 Hope Road,
Kingston 10

876.929.1153

876.929.3457

Email: ihomes@cwjamaica.com

www.islandhomesja.com

Optional upgrades:

- Master suite shower stall
- Light fixtures
- Decorative grilles on all windows
- Spacious outdoor patio with pavers and trellis
- Polyurethane Foam insulation to ceiling

Choose your kitchen option:

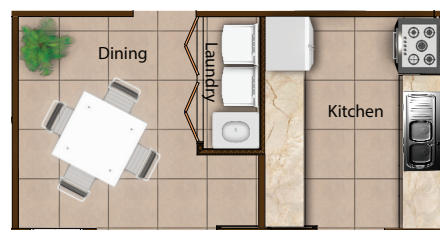

Pass-through



Walk-through

Bay Front is a development of Portmore Marina Developments Ltd., 20 Hope Road, Kingston 10, Registration DV1182. Bay Front Villa homes (Phase I) on lots of 2,510 - 6,132 sq ft. Stated price is subject to escalation and may change without notice. Estimated completion October 2015. Renovation approved by the Portmore Municipal Council on March 26, 2015. Walls and roof: reinforced concrete; Floors: ceramic tiles. Plans on file at the on-site model unit.